

JFL-19 bridge weight sensor

- Bridge type, classic model for truck scales
- Install convenient, high reliability, stable and accurate weighing, long working time, high cost-effectiveness
- Can choose analog model, digital model, anti-lightning model, low temperature resistance model, high temperature resistance model
- suitable for truck scale, platform scale, railway scale, etc.

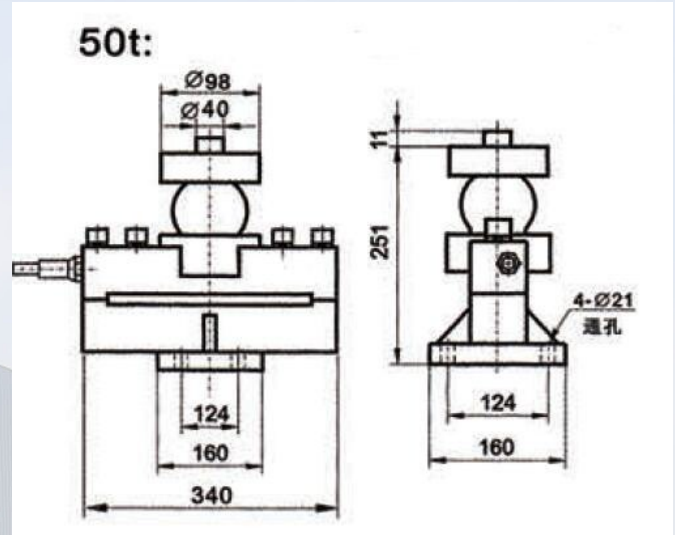
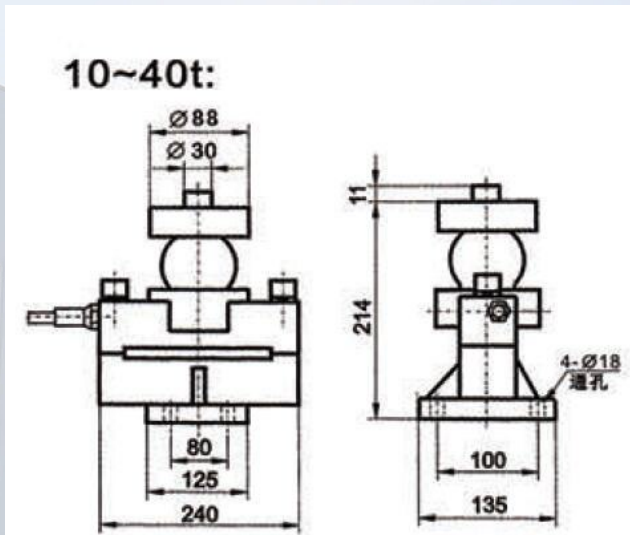

Technical parameters

Model: JFL-19	Material: good quality alloy steel
Capacity: 20T-50T	Output resistance: 700±3Ω
Output sensitivity: 2.0±10%MV/V	Input resistance: 750±10Ω
Zero point output: ±1%FS	Comprehensive error: ≤±0.03%
Nonlinear: 0.03%FS	Repeatability: 0.03%FS
Excitation voltage: 5-15V	Working temperature range: -20°C to +70°C
Safe overload: 150%	Ultimate overload: 200%
Cable: φ5.7x16m, φ5.7x12m, φ5.7x18m	Insulation resistance: ≥5000MΩ(50V)
Cable connection: red: Power + black: Power - green: signal + white: signal - (can be 6 core wire)	